

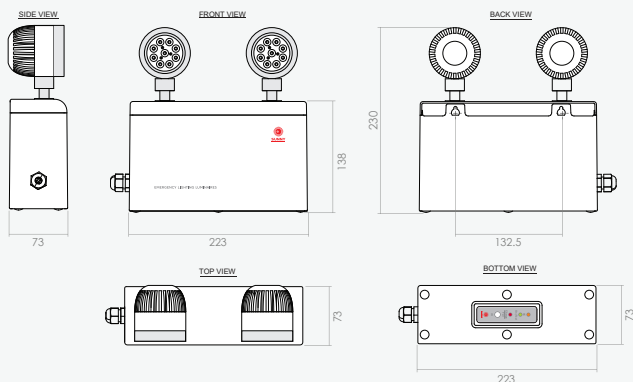

### Technical Specifications

Mode of Operation	Non-Maintained
Operation Temperature	-15 to 75°C
Input Voltage	230 VAC / 50Hz
LED Lamp Power	9W / Bulb
Color Temperature	Daylight (7000K ± 250K)
Luminous Intensity	675 lm, Daylight
Rated Beam Angle	50Deg
Battery Type / Capacity	Lithium Iron Phosphate (LiFePO4) 3.2V-6000mAh
Protection Features	- AC, DC Fuse - Battery Low Voltage Cut-Off - Surge Protection
Testing Systems	- Auto Check - Auto Test - Remote Test
Charging Method	3 Steps Charger System
Charging Period	10-15 Hrs
Backup Time	3.0 Hrs
Housing	Plastic Polycarbonate Anti Ultraviolet (PC-UV) Casing
Dimensions (L x W x H)	223 x 73 x 230 mm
Weight	1.47 Kg
Degree of Protection	IP66
Mounting	Wall Surface
Accessory	Infrared Remote Test (RT-S3)
Standards / Compliance	- TIS.1955-2551 - ISO9001 - CE

### Dimensions (mm)



### Product Overview

The emergency light fixture is equipped with a weatherproof rating of IP66, suitable for both indoor and outdoor installation within a temperature range of -15 to 75 degrees Celsius. It is designed for areas where temperature control is necessary and where it may be exposed to environmental conditions such as water droplets or dust. The housing is made of Polycarbonate Anti-Ultraviolet (PC-UV) plastic, capable of withstanding direct UV sunlight exposure and providing excellent impact resistance to prevent breakage. It also effectively shields the internal components from external heat, ensuring that it does not impact the battery and helping to extend the operational lifespan.

### Features

#### Bulb

- Highly efficient and super bright 9 Watts LEDs provides maximum brightness while saving on power consumption. It also offers long operational life of more than 50,000 hours

#### Battery

- Use Lithium Iron Phosphate (LiFePO4) 3.2V-6000mAh, backup power for 3 hours. It has the advantages of light weight, long service life and high power. It also causes less pollution

#### Functions

- Auto Check for key components abnormalities such as the battery, bulbs, fuses, lighting circuits, and battery charging system
- Auto Test schedule: 1 month every 60 seconds, 1 year every 120 minutes (according to standard TIS.021004-22), activate and deactivate functions with a remote control
- A 5-second, 30-minute or 60-minute self-test can be performed on the unit using the remote

#### Circuit Systems

- Controlled by an 8-bit microcontroller circuit
- A Timer Delay circuit to keep the unit operating for a few more seconds once normal power has returned

#### Protection Features

- AC and DC fuse to prevent current overload
- Surge Protection
- IP66 dust and water resistant

#### Features to Extend Battery Life

- An innovative 3 Steps Charger System
- A Low Voltage Cut-Off to prevent the battery from draining completely
- Continuous monitoring and checking system for the battery charging status
- Battery voltage change rate monitoring system with respect to time (dv/dt)

#### Warning Systems

- Alert for device not ready for use
- Alert for AC input not connected to the device and notification for rectifier circuit malfunction
- An LED will blink 3 times every 15 seconds to indicate that the system performs an automatic battery test (Auto Test) and detects that the backup lighting emergency duration is less than 120 minutes (Battery Fail)
- An LED will blink 4 times every 15 seconds to indicate that there is a problem charging the battery (Charging Fail)
- An LED will blink 5 times every 15 seconds to indicate that an abnormality in the lighting system (Lighting Fail)

### Indicators



- LED AC** - Indicates that the unit is receiving a power supply
- LED On/Test** - Indicates that the unit is receiving a power / Indicates that the unit is set to perform automatic self-tests / Indicates if the unit is performing a self-test
- LED Charge/Fail** - Indicates that the unit's battery is charging or is a problem with the battery
- IR** - Infrared signal receiver