



Product Overview

The Self-Contained Emergency Light Luminaires CU212ST3 uses two 12V 12W SMD LED lamps for lighting.

The device is controlled by the microcontroller. Thus, it can be activated by either pressing the Function Test button on the device or by remote testing.

The housing is made from Grade 304 stainless steel protected against jets of water and dust tight, certified by Electrical and Electronics Institute for IP 66 standard.

Technical Specifications

Mode of Operation	Non-Maintained
Input Voltage	220 VAC / 50Hz \pm 10%
Output Voltage	12VDC
LED Lamp Power	12W / Bulb
Color Temperature	6,000k \pm 250k 3,000k \pm 250k
Rated Beam Angle	50Deg
Battery Type / Capacity	Sealed Lead-Acid Maintained Free 12V-5Ah
Protections	- AC, DC Fuse - Battery Low Voltage Cut-Off - Surge Protection
Testing Systems	- Automatic Testing - Manual Testing or Remote Testing
Charging Mode	Constant Voltage & Limit Current
Charging Current	500mA
Charging Time	10-15 Hrs
Backup Time	3.0 Hrs
Housing	Grade 304 stainless steel
Dimensions (LxWxH)	270 x 90 x 250 mm
Weight	3.27 Kg
IP Rating	66

Features

- Having LED lifetime of over 50,000 hours
- Automatically recharged with constant voltage and limited current
- Battery overcharge protection circuit prevents overcharge which is the cause of battery swelling
- Battery discharge protection circuit prolongs the battery life
- Under voltage protection circuit allows the unit to automatically activate the emergency light in case any fault occurs in the main power distribution system or in case of power failure (140-160VAC)
- Allowing testing with a remote control
- Automatically enabling a 30 minutes test every 30 days (The Auto Test can be disabled)
- Having a battery charging reminder with voice alert (Battery Checker)

Dimensions (mm)

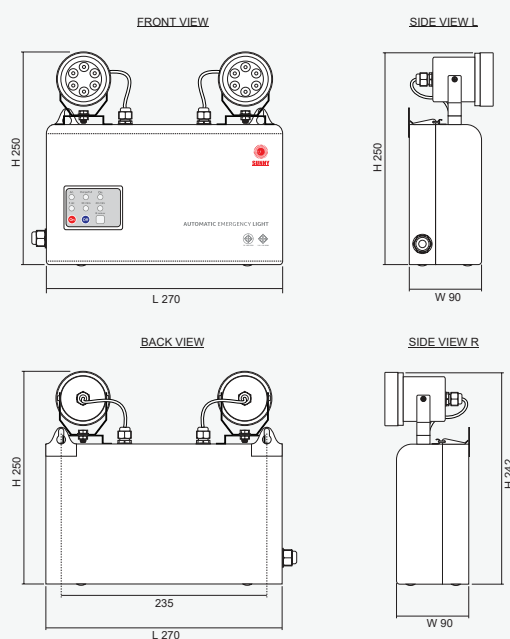

Indicators

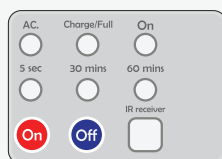

- LED AC** ▶ Indicates input status
- LED Charge/Full** ▶ Indicates charging status
- LED ON** ▶ Indicates ready for use status
- LED 5sec** ▶ Indicates that the 5 seconds test is enable
- LED 30mins** ▶ Indicates that the 30 minutes test is enable
- LED 60mins** ▶ Indicates that the 60 minutes test is enable
- Switch ON** ▶ Press to turn on the device
- Switch OFF** ▶ Press to turn off the device
- IR Receiver** ▶ Infrared signal receiver from the infrared remote